

CRE



1211/38-52 College Street Darlinghurst NSW

1 1

Opposite Hyde Park in the cultural heart of the city, this oversized studio apartment offers a superb opportunity to buy in the newly revamped Hyde Park Plaza. Set high to the quiet rear of the full services building, the bright modern studio faces north with a sunny balcony capturing harbour glimpses along with sweeping urban views down to East Sydney. Crowned with a recently landscaped rooftop entertainer's haven, the neat and tidy apartment features access to exceptional facilities including a state-of-the-art gym, sunny rooftop pool, sauna and spa with views that sweep over the harbour and Hyde Park. Offering superb walkability on the edge of the CBD, the location is unbeatable with Oxford Street's world of arts, fashion and entertainment just around the corner.

View : <https://www.coogeerealestate.com.au/sale/nsw/eastern-suburbs/darlinghurst/residential/unit/7996511>



James Giltinan
02 9665 3341

- + Peaceful rear position high on level 12, level lift access
- + 40sqm approx. layout with a north aspect, sunlit interiors

<https://www.coogeerealestate.com.au>

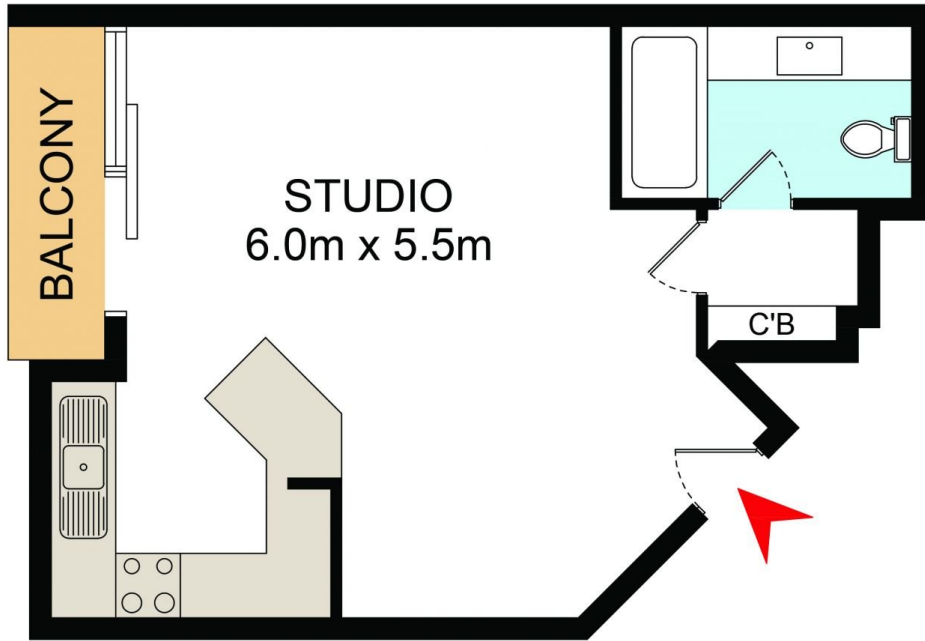

LEVEL 12



DISCLAIMER: THIS IS FOR ILLUSTRATIVE PURPOSES ONLY.
ALL DIMENSIONS ARE APPROXIMATE AND IT DOES NOT
CONSTITUTE PART OF ANY LEGAL DOCUMENTS.

1211/38 College Street

Darlinghurst