

# CRE



**8/109 Clovelly Road Randwick NSW**

1  1 

A quiet setting to the rear of the boutique Riviera underlines a sense of peace and privacy in this first-floor security apartment on the edge of Clovelly village. The well-proportioned one bedroom apartment is superbly located an easy walk to Centennial Park and Frenchmans Road's cafe strip. With a sunny north aspect and only one common wall, this quiet hideaway offers low maintenance living in a highly sought-after location with close proximity to Clovelly and Bronte Beaches.

**View** : <https://www.coogeeestate.com.au/lease/nsw/eastern-suburbs/randwick/residential/apartment/5903808>



**Alicia Ellison**  
**02 9665 3341**

- Secluded setting to the rear of a well maintained block of 16
- Large bedroom with a leafy outlook and a tidy bathroom
- Bright open plan living flanked by a sleek streamlined kitchen
- Coin Operated Share Laundry
- Close to Queens and Centennial Parks, easy access to

<https://www.coogeeestate.com.au>

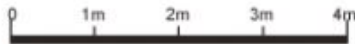
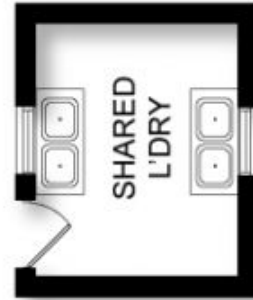
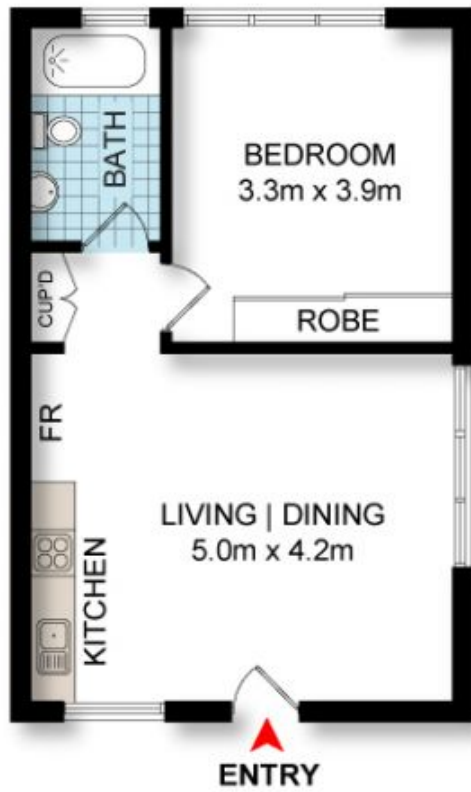

DISCLAIMER: THIS IS FOR ILLUSTRATIVE PURPOSES ONLY.  
ALL DIMENSIONS ARE APPROXIMATE AND IT DOES NOT  
CONSTITUTE PART OF ANY LEGAL DOCUMENTS.

8/109 Clovelly Road,

Randwick